

GENERAL NOTES.

G1. THESE NOTES APPLY TO ALL CIVIL/STRUCTURAL DRAWINGS ISSUED ON THIS PROJECT

G2. CIVIL/STRUCTURAL DRAWINGS SHALL BE READ IN CONJUNCTION WITH ALL RELATED PROJECT DOCUMENTATION. ANY DISCREPANCY IN THE PROJECT DOCUMENTATION AFFECTING WORK SHOWN ON THESE DRAWINGS SHALL BE REFERRED TO THE PROJECT ENGINEER AND AN INSTRUCTION OBTAINED BEFORE PROCEEDING WITH WORK SO AFFECTED.

G3. VERIFY SETTING OUT DIMENSIONS SHOWN ON THESE DRAWINGS BEFORE COMMENCING WORK.

G4. EXECUTE ALL WORK SHOWN ON THESE DRAWINGS IN ACCORDANCE WITH THE RELEVANT AUSTRALIAN CODES, STANDARDS AND LOCAL GOVERNMENT ORDINANCES.

G5. ENSURE THAT ALL STRUCTURE IS MAINTAINED IN A SAFE AND STABLE STATE THROUGHOUT THE CONSTRUCTION PERIOD.

G6. U.N.O. STANDARDS/CODES REFERENCED SHALL BE THOSE CURRENT AT THE DATE DRAWINGS WERE APPROVED.

G7. SERVICE LOCATIONS SHOWN ON PLAN ARE APPROXIMATE ONLY. CARE MUST BE TAKEN DURING EXCAVATION. LOCATE ALL SERVICES & MAINS ON SITE PRIOR TO CONSTRUCTION.

G8. N25 CONCRETE WITH SL72 REINFORCEMENT IN ACCORDANCE WITH AS 1379 AND AS 3600.

G9. 2.5m WIDE SHAREWAY WITH 'CONNELLY KEY' JOINTS OR SAW CUTS @ 3m CTRS.

G10. EXPANSION JOINTS @ 12m CTRS.

G11. BROOM FINISH @ RIGHT ANGLE TO DIRECTION OF TRAVEL.

G12. WHERE NEW CONCRETE WORKS MEETS EXISTING CONCRETE PATHS, KERB RAMPS & DRIVEWAYS, A DOWELLED EXPANSION JOINT SHOULD BE CONSTRUCTED WITH 300mm x 12mm DIA. DOWELS @ 400mm CTRS.

G12. NEW KERB RAMPS TO BE CONSTRUCTED IN ACCORDANCE WITH AS 1428.1.

LEGEND

Min. 125mm thick shareway with SL72 reinforcement



Min. 150mm thick driveway with SL82 reinforcement



Kerb ramps



Existing concrete works



30mm AC shoulder seal



LOCALITY DIAGRAM
N.T.S.

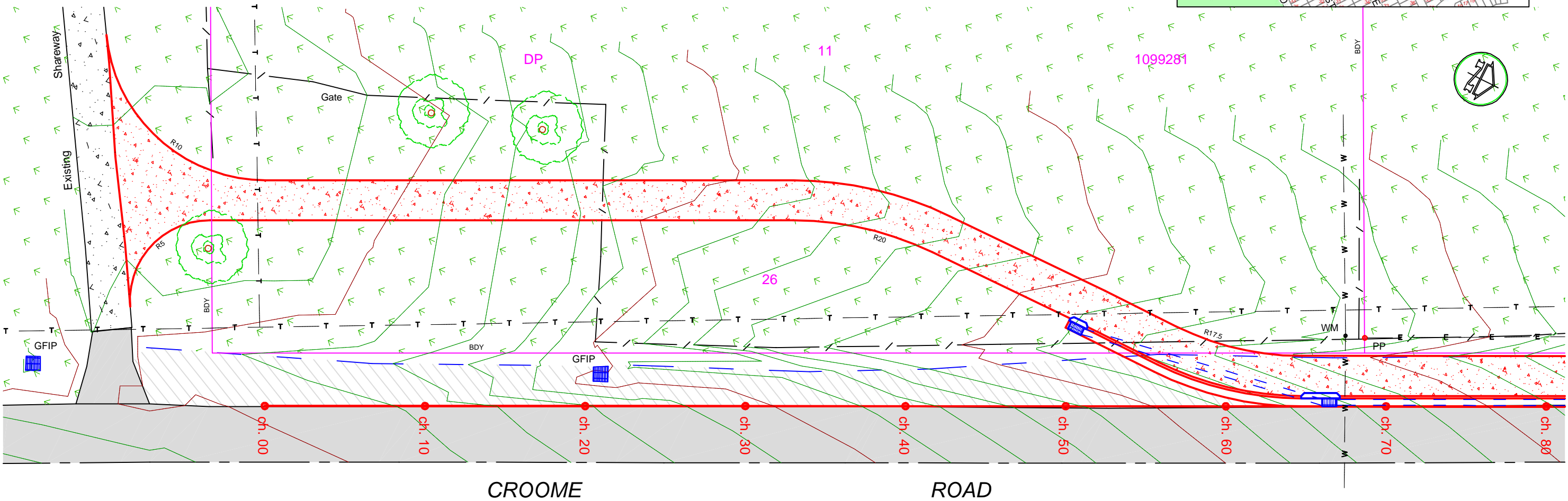
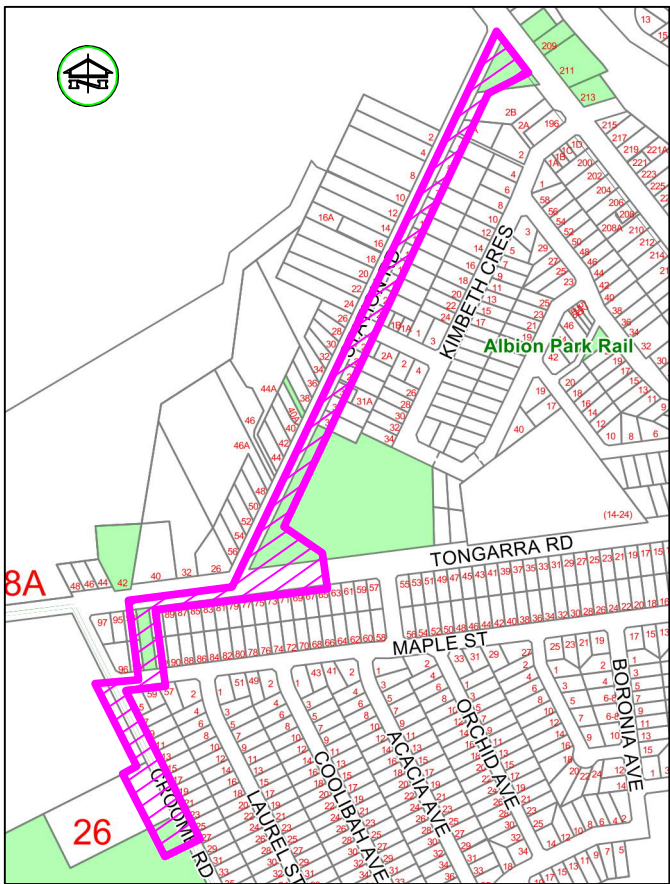

SCALES		LIST OF REVISIONS		AMENDMENT DETAILS		APPROVED - Manager Technical Services		LOCATIONS		SERVICES		LEGEND		ADMINISTRATION CENTRE		PLAN DETAILS		FILE:		REVISION	
1:125 @ A1	1:250 @ A3	REV.	DATE	OFFICER		DESIGNED: PCW	DATE: November 2018	SEDIMENT AND EROSION CONTROL	Provide sediment and erosion control measures in accordance with the 'Erosion & Sediment Control' guide by the NSW Office of Environment & Heritage	Gas: — G —	Electricity: — E —	Water: — W —	Sewer: — S —	Shellharbour City Centre	76 CYGNET AVENUE (Cnr Cygnet & College Avenue)	PROPOSED SHAREWAY		W:\Design Projects\2018_2019 Design Projects\7C65 - Proposed Shareway, Croome Road to Princes Highway via Station Road, APR\7C65.dwg		O	
SURVEYED		OFFICER: MS		DATE: October 2018		DATE: November 2018	PCW	DRAWN: PCW		DATE: November 2018		TelComm Local Cable: — T —		TelComm Major or Optic Fibre: — MOF —		POSTAL ADDRESS		PLAN No:		SHEET:	
G.P.S.																7C65		1 of 10			

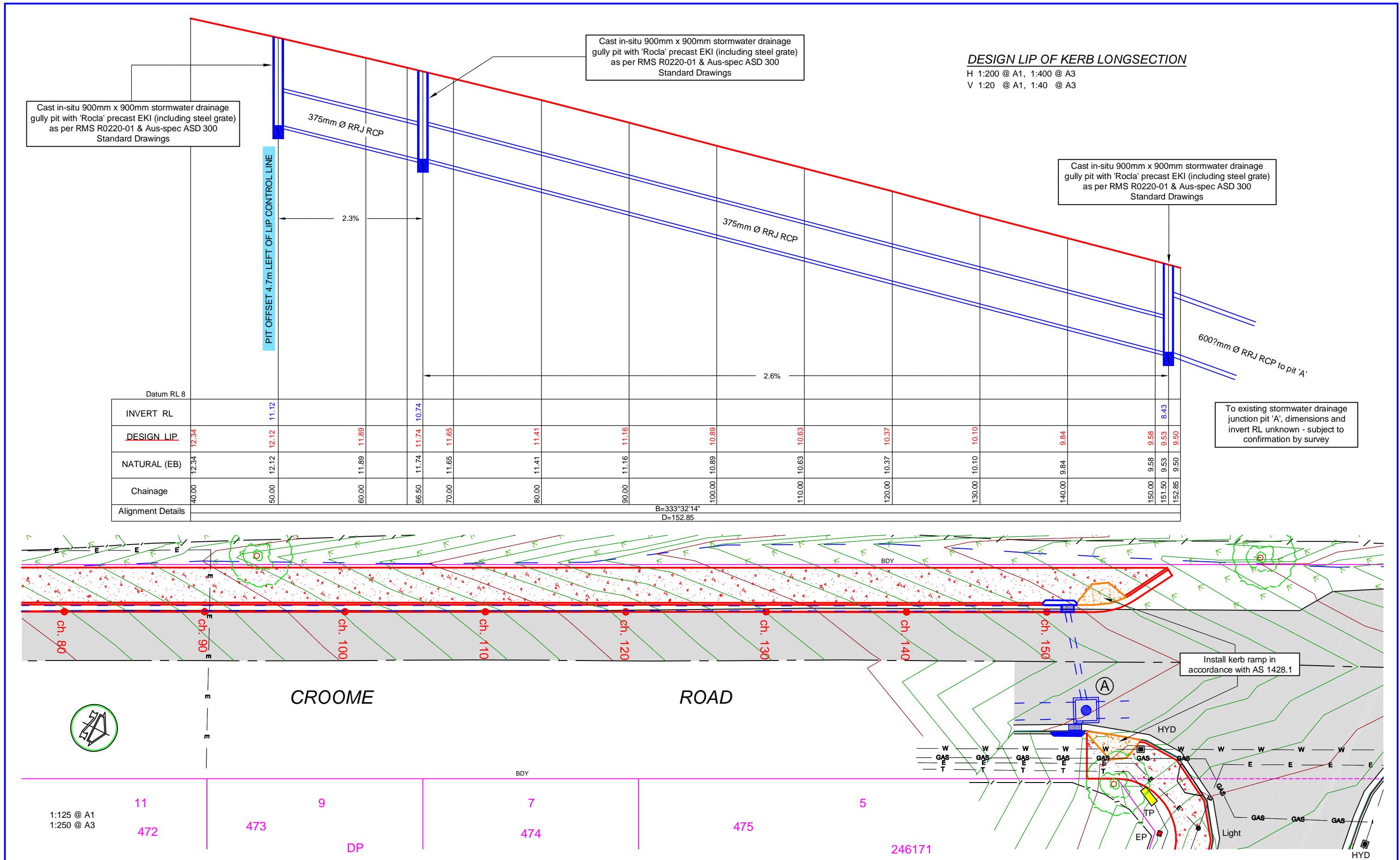

SCALES
As Shown

SURVEYED
OFFICER: MS
DATE: October 2018

SURVEY MARKS:
G.P.S.

LIST OF REVISIONS
REV. DATE OFFICER

AMENDMENT DETAILS

APPROVED - Manager Technical Services

DATE: November 2018

DESIGNED: PCW
DATE: November 2018

DRAWN: PCW
DATE: November 2018

LOCATIONS
Services shown are those known to exist at date of design. Prior to commencement of excavation contact the relevant gas, electricity, water and telecommunications service providers, including the RMS, for most recent service locations and precautions that may be necessary

SERVICES
Gas: — G —
Electricity: — E —
Water: — W —
Sewer: — S —
TelComm Local Cable: — T —
TelComm Major or Optic Fibre: — MOF —

LEGEND
Gas: — G —
Electricity: — E —
Water: — W —
Sewer: — S —
TelComm Local Cable: — T —
TelComm Major or Optic Fibre: — MOF —

SHELLHARBOUR CITY COUNCIL

ADMINISTRATION CENTRE
SHELLHARBOUR CIVIC CENTRE
76 CYGNET AVENUE
(Cnr Cygnet & College Avenue)

POSTAL ADDRESS
Locked Bag 155
SHELLHARBOUR CITY CENTRE NSW 2529
PH: (02) 4221 6111
FAX: (02) 4221 6016
DX26402 SHELLHARBOUR CITY CENTRE

PLAN DETAILS
PROPOSED SHAREWAY
CROOME ROAD to PRINCES HIGHWAY
via. STATION ROAD
ALBION PARK RAIL

FILE:
W:\Design Projects\2018_2019 Design Projects\7C65 - Proposed Shareway, Croome Road to Princes Highway via Station Road, APR\7C65.dwg

PLAN No:
7C65

REVISION
O

SHEET:
2 of 10

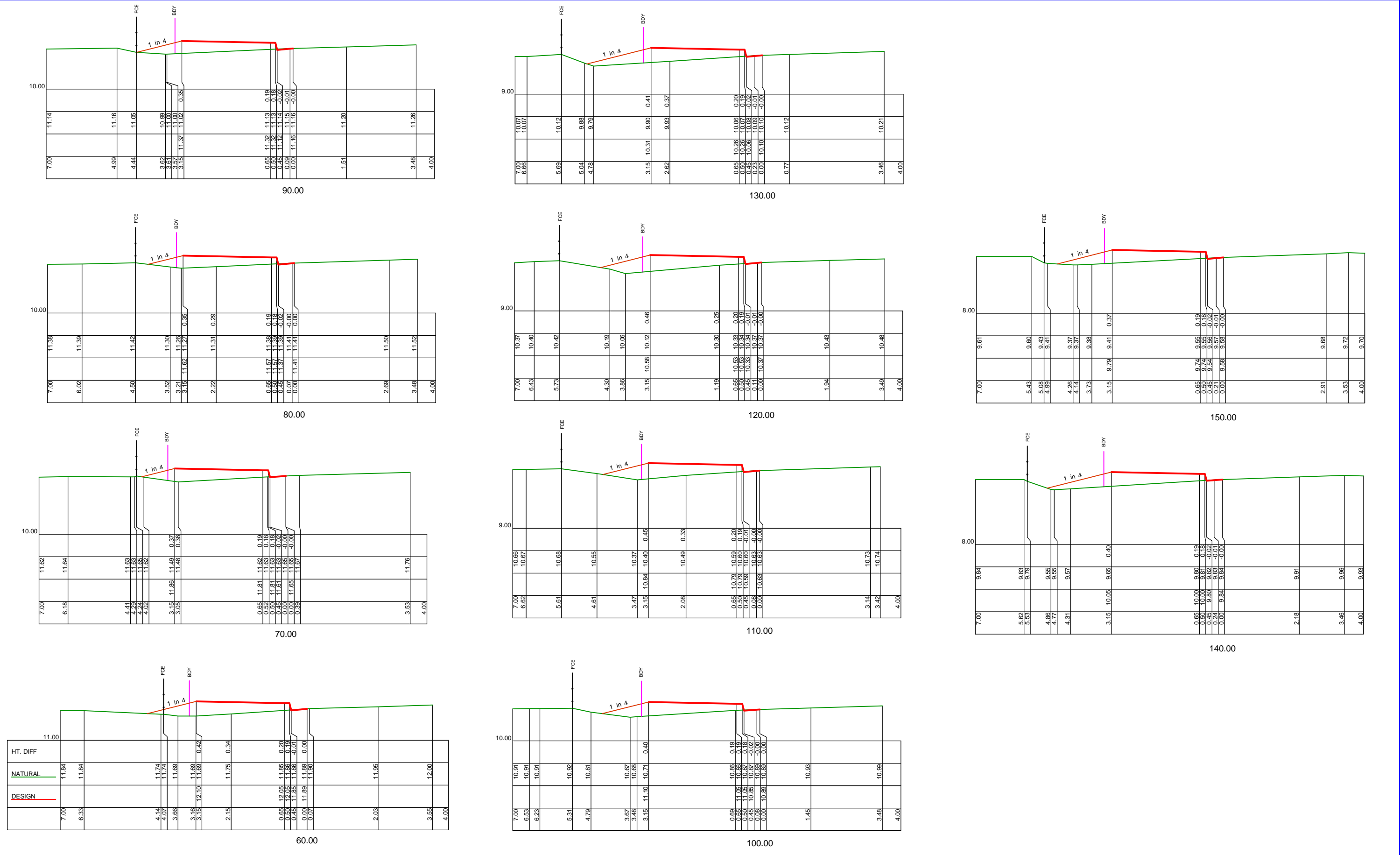

SCALES		LIST OF REVISIONS		AMENDMENT DETAILS		APPROVED - Manager Technical Services		LOCATIONS		SERVICES		LEGEND		ADMINISTRATION CENTRE SHELLHARBOUR CIVIC CENTRE 76 CYGNET AVENUE (Cnr Cygnet & College Avenue)		PLAN DETAILS		FILE:		REVISION		
H 1:50 @ A1, 1:100 @ A3 V 1:50 @ A1, 1:100 @ A3		REV.	DATE	OFFICER	 DATE: November 2018		DESIGNED: PCW		SEDIMENT AND EROSION CONTROL Provide sediment and erosion control measures in accordance with the 'Erosion & Sediment Control' guide by the NSW Office of Environment & Heritage		Gas: — G — Electricity: — E — Water: — W — Sewer: — S — TelComm Local Cable: — T — TelComm Major or Optic Fibre: — MOF —		 Shellharbour CITY COUNCIL		POSTAL ADDRESS Locked Bag 155 SHELLHARBOUR CITY CENTRE NSW 2529 PH: (02) 4221 6111 FAX: (02) 4221 6016 DX26402 SHELLHARBOUR CITY CENTRE		PROPOSED SHAREWAY CROOME ROAD to PRINCES HIGHWAY via. STATION ROAD ALBION PARK RAIL		W:\Design Projects\2018_2019 Design Projects\7C65 - Proposed Shareway, Croome Road to Princes Highway via Station Road, APR\7C65.dwg		O	
SURVEYED OFFICER: MS DATE: October 2018						DATE: November 2018												PLAN No:		SHEET:		
SURVEY MARKS: G.P.S.																		7C65		3 of 10		

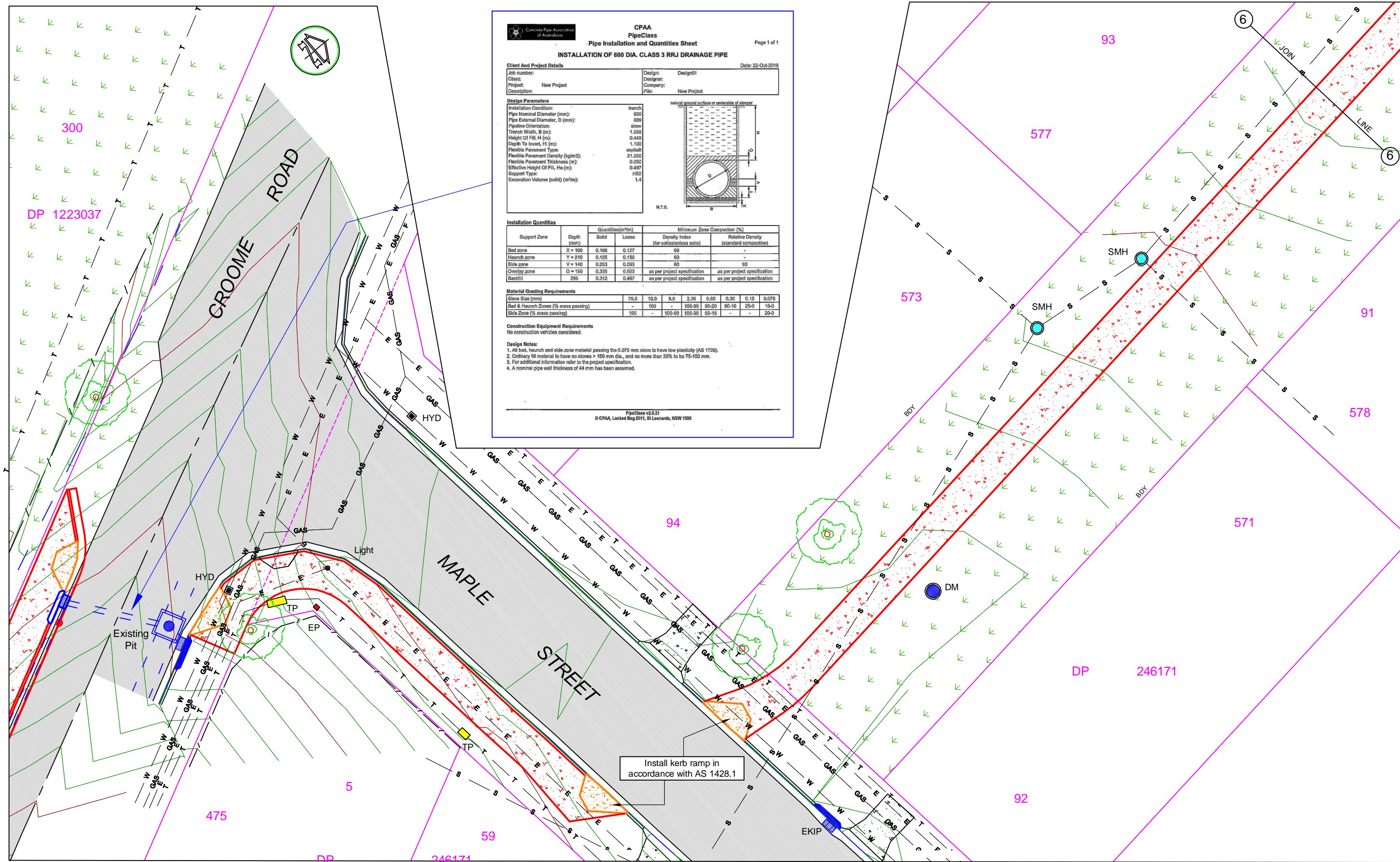

SCALES
1:125 @ A1
1:250 @ A3

SURVEYED
OFFICER: MS
DATE: October 2018
SURVEY MARKS:
G.P.S.

LIST OF REVISIONS
REV. DATE OFFICER

AMENDMENT DETAILS

APPROVED - Manager Technical Services

DATE: November 2018

DESIGNED: PCW
DATE: November 2018

SEDIMENT AND EROSION CONTROL
Provide sediment and erosion control measures in accordance with the 'Erosion & Sediment Control' guide by the NSW Office of Environment & Heritage

LOCATIONS
Services shown are those known to exist at date of design. Prior to commencement of excavation contact the relevant gas, electricity, water and telecommunications service providers, including the RMS, for most recent services locations and precautions that may be necessary

SERVICES
Gas: — G —
Electricity: — E —
Water: — W —
Sewer: — S —
TelComm Local Cable: — T —
TelComm Major or Optic Fibre: — MOF —

LEGEND

SHELLHARBOUR CITY COUNCIL

ADMINISTRATION CENTRE
SHELLHARBOUR CIVIC CENTRE
76 CYGNET AVENUE
(Cnr Cygnet & College Avenue)

POSTAL ADDRESS
Locked Bag 155
SHELLHARBOUR CITY CENTRE NSW 2529
PH: (02) 4221 6111
FAX: (02) 4221 6016
DX26402 SHELLHARBOUR CITY CENTRE

PLAN DETAILS
PROPOSED SHAREWAY
CROOME ROAD to PRINCES HIGHWAY
via. STATION ROAD
ALBION PARK RAIL

FILE:
W:\Design Projects\2018_2019 Design Projects\7C65 - Proposed Shareway, Croome Road to Princes Highway via Station Road, APR\7C65.dwg

REVISION
O

PLAN No:
7C65

SHEET:
4 of 10

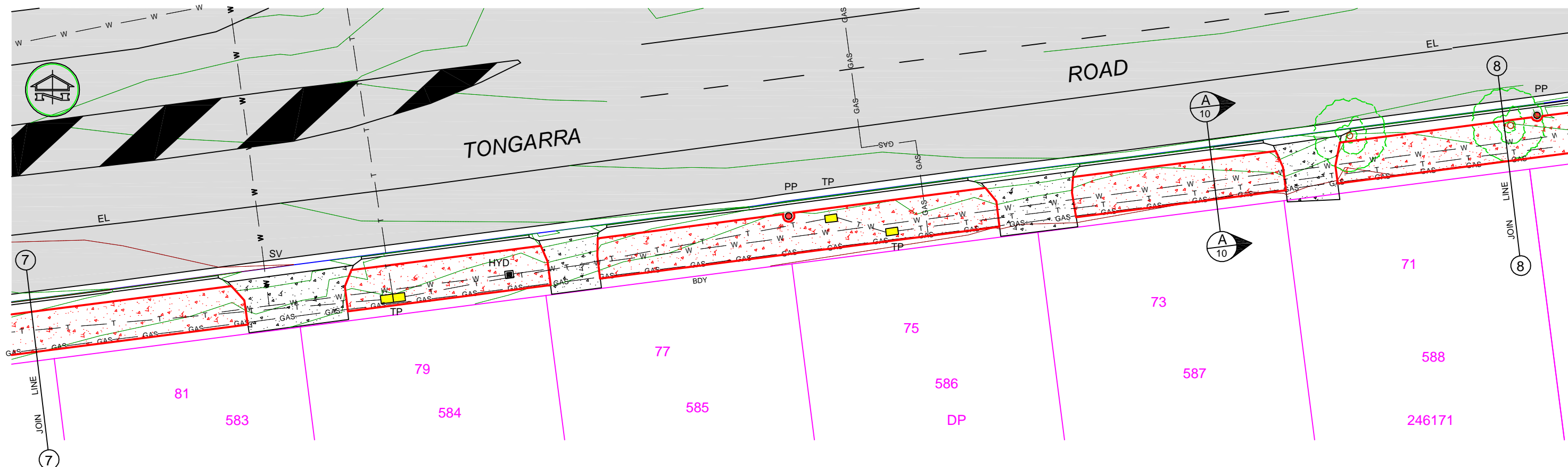
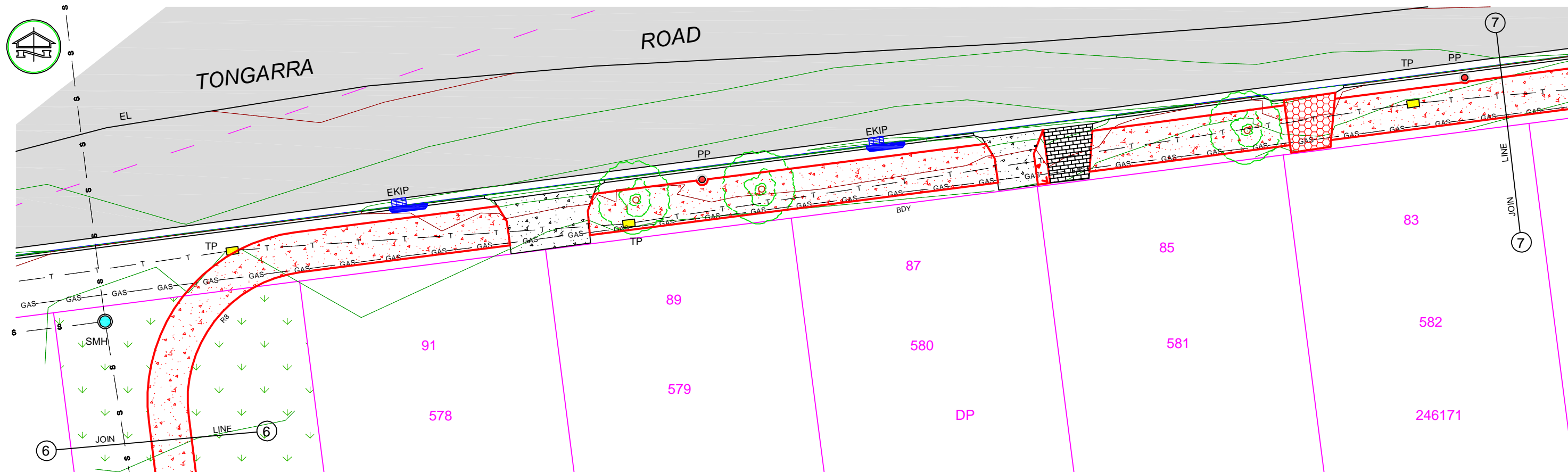

<div>SCALES</div> <div>1:125 @ A1</div> <div>1:250 @ A3</div>		<div>LIST OF REVISIONS</div> <div>REV. DATE OFFICER</div> <div>.....</div> <div>.....</div> <div>.....</div> <div>.....</div> <div>.....</div> <div>.....</div> <div>.....</div> <div>.....</div> <div>.....</div> <div>.....</div>		<div>AMENDMENT DETAILS</div> <div>.....</div> <div>.....</div> <div>.....</div> <div>.....</div> <div>.....</div> <div>.....</div> <div>.....</div> <div>.....</div> <div>.....</div> <div>.....</div>		<div>APPROVED - Manager Technical Services</div> <div><div><div>Adm. De Coo</div><div>DATE: November 2018</div></div><div><div>DESIGNED: PCW</div><div>DATE: November 2018</div></div><div><div>DRAWN: PCW</div><div>DATE: November 2018</div></div></div> <div><div>SEDIMENT AND EROSION CONTROL</div><div>Provide sediment and erosion control measures in accordance with the 'Erosion & Sediment Control' guide by the NSW Office of Environment & Heritage</div></div>		<div>LOCATIONS</div> <div>Services shown are those known to exist at date of design. Prior to commencement of excavation contact the relevant gas, electricity, water and telecommunications service providers, including the RMS, for most recent service locations and precautions that may be necessary</div>		<div>SERVICES</div> <div><div>Gas: — G —</div><div>Electricity: — E —</div><div>Water: — W —</div><div>Sewer: — S —</div><div>TelComm Local Cable: — T —</div><div>TelComm Major or Optic Fibre: — MOF —</div></div> <div><div><div><div></div><div>Shellharbour CITY COUNCIL</div></div></div></div> <div><div>ADMINISTRATION CENTRE</div><div>SHELLHARBOUR CIVIC CENTRE</div><div>76 CYGNET AVENUE</div><div>(Cnr Cygnet & College Avenue)</div><div>POSTAL ADDRESS</div><div>Locked Bag 155</div><div>SHELLHARBOUR CITY CENTRE NSW 2529</div><div>PH: (02) 4221 6111</div><div>FAX: (02) 4221 6016</div><div>DX26402 SHELLHARBOUR CITY CENTRE</div></div>		<div><div>PLAN DETAILS</div><div>PROPOSED SHAREWAY</div><div>CROOME ROAD to PRINCES HIGHWAY</div><div>via. STATION ROAD</div><div>ALBION PARK RAIL</div></div>				<div>FILE:</div> <div>W:\Design Projects\2018_2019 Design Projects\7C65 - Proposed Shareway, Croome Road to Princes Highway via Station Road, APR\7C65.dwg</div>		<div>REVISION</div> <div>O</div>	
<div>SURVEYED</div> <div>OFFICER: MS</div> <div>DATE: October 2018</div> <div>SURVEY MARKS:</div> <div>G.P.S.</div>										<div>PLAN No:</div> <div>7C65</div>		<div>SHEET:</div> <div>5 of 10</div>							

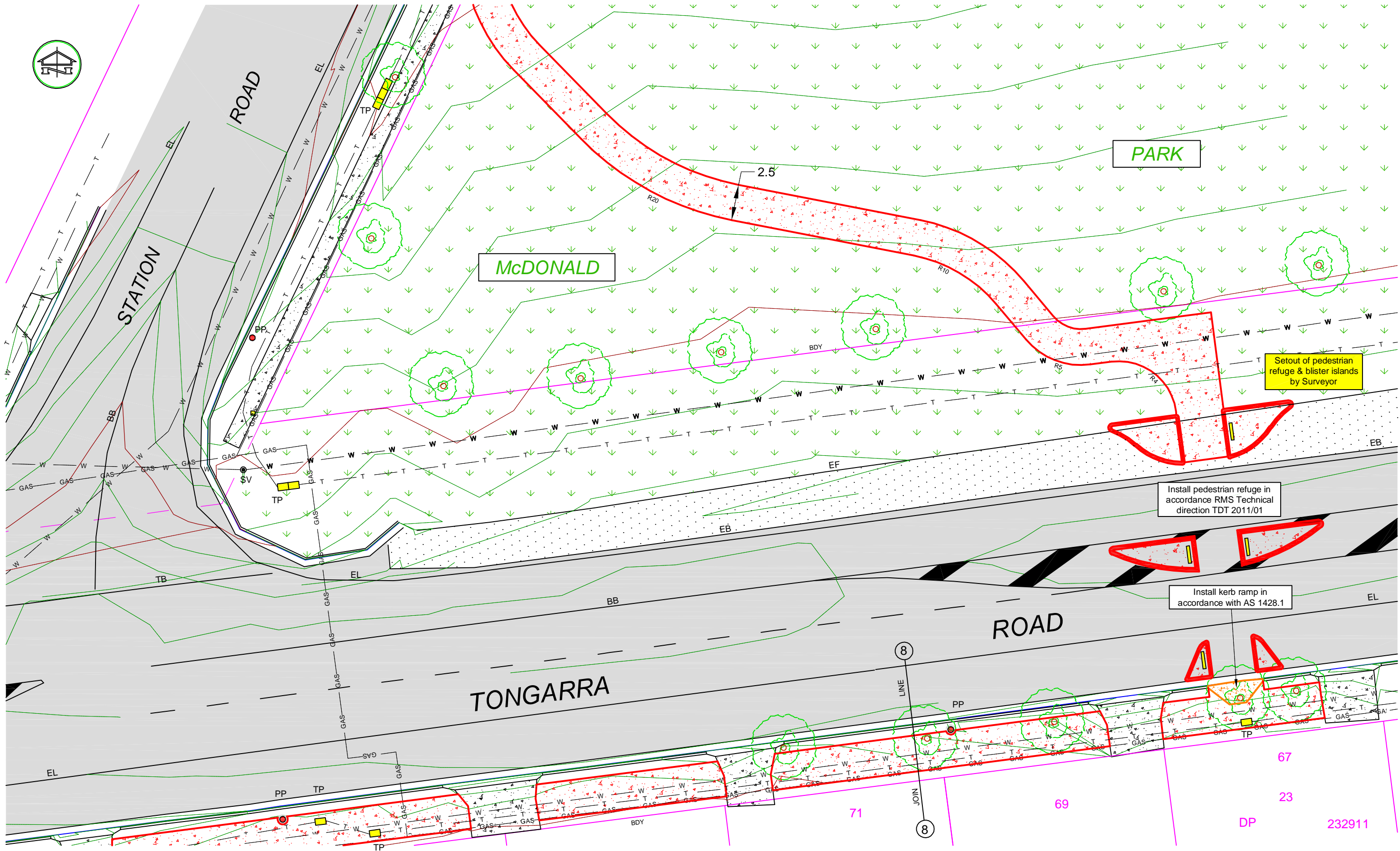

<div>SCALES</div> <div>1:125 @ A1</div> <div>1:250 @ A3</div>		<div>LIST OF REVISIONS</div> <div>REV. DATE OFFICER</div> <div>.....</div> <div>.....</div> <div>.....</div> <div>.....</div> <div>.....</div> <div>.....</div> <div>.....</div> <div>.....</div> <div>.....</div> <div>.....</div>		<div>AMENDMENT DETAILS</div>		<div>APPROVED - Manager Technical Services</div> <div><div><div>Adrian De Coster</div></div><div>DATE: November 2018</div></div>		<div>LOCATIONS</div> <div>Services shown are those known to exist at date of design. Prior to commencement of excavation contact the relevant gas, electricity, water and telecommunications service providers, including the RMS, for most recent service locations and precautions that may be necessary</div>		<div>SERVICES</div> <div><div>Gas: — G —</div><div>Electricity: — E —</div><div>Water: — W —</div><div>Sewer: — S —</div><div>TelComm Local Cable: — T —</div><div>TelComm Major or Optic Fibre: — MOF —</div></div>		<div><div><div><div></div></div><div>Shellharbour</div><div>CITY COUNCIL</div></div><div><div>ADMINISTRATION CENTRE</div><div>SHELLHARBOUR CIVIC CENTRE</div><div>76 CYGNET AVENUE</div><div>(Cnr Cygnet & College Avenue)</div><div>POSTAL ADDRESS</div><div>Locked Bag 155</div><div>SHELLHARBOUR CITY CENTRE NSW 2529</div><div>PH: (02) 4221 6111</div><div>FAX: (02) 4221 6016</div><div>DX26402 SHELLHARBOUR CITY CENTRE</div></div></div>		<div>PLAN DETAILS</div> <div>PROPOSED SHAREWAY</div> <div>CROOME ROAD to PRINCES HIGHWAY</div> <div>via. STATION ROAD</div> <div>ALBION PARK RAIL</div>				<div>FILE:</div> <div>W:\Design Projects\2018_2019 Design Projects\7C65 - Proposed Shareway, Croome Road to Princes Highway via Station Road, APR\7C65.dwg</div>		<div>REVISION</div> <div>O</div>	
<div>SURVEYED</div> <div>OFFICER: MS</div> <div>DATE: October 2018</div> <div>SURVEY MARKS:</div> <div>G.P.S.</div>						<div>DESIGNED: PCW</div> <div>DATE: November 2018</div>		<div>SEDIMENT AND EROSION CONTROL</div> <div>Provide sediment and erosion control measures in accordance with the 'Erosion & Sediment Control' guide by the NSW Office of Environment & Heritage</div>						<div>PLAN No:</div> <div>7C65</div>		<div>SHEET:</div> <div>6 of 10</div>					

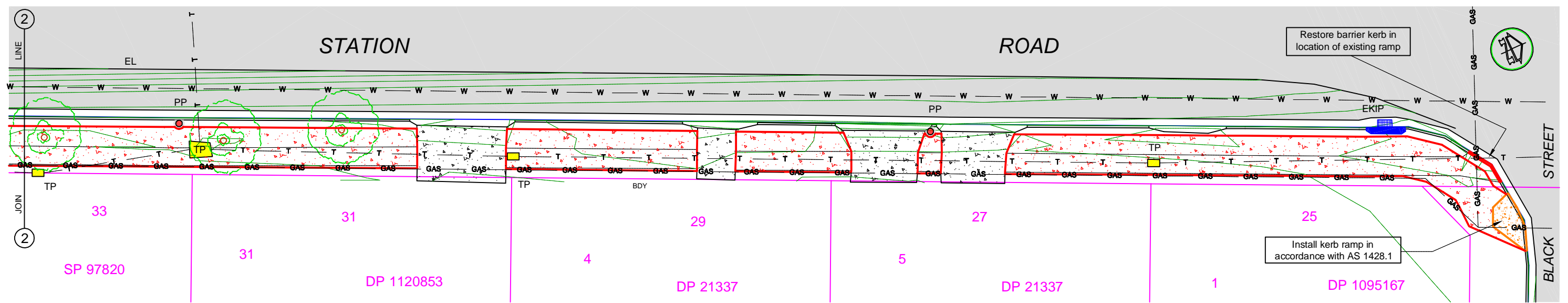
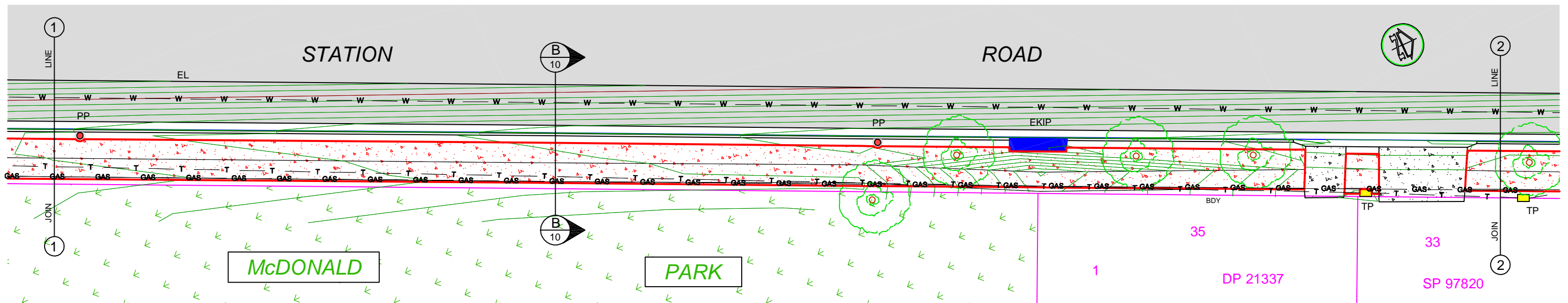
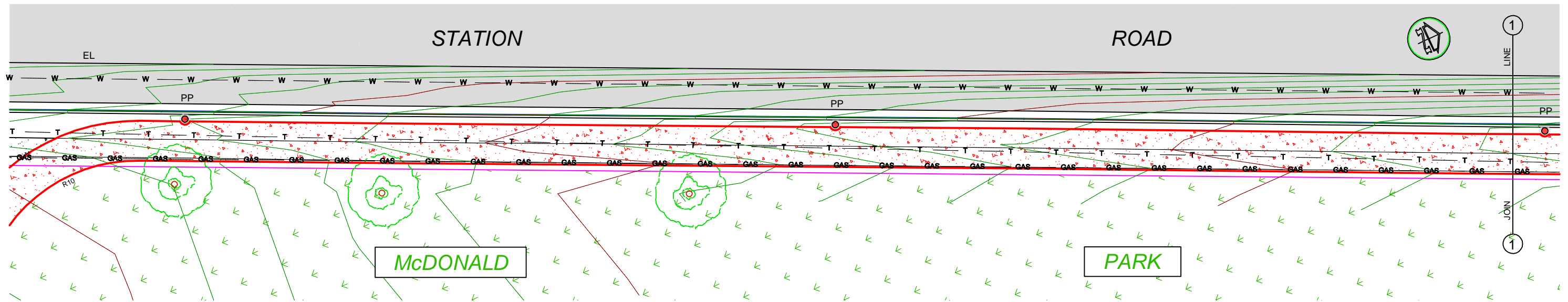

<div>SCALES</div> <div>1:125 @ A1</div> <div>1:250 @ A3</div>		<div>LIST OF REVISIONS</div> <div>REV. DATE OFFICER</div> <div>.....</div> <div>.....</div> <div>.....</div> <div>.....</div> <div>.....</div> <div>.....</div> <div>.....</div> <div>.....</div> <div>.....</div> <div>.....</div>		<div>AMENDMENT DETAILS</div>		<div>APPROVED - Manager Technical Services</div> <div><div><div><div></div><div>Adm. R. Carruth</div></div></div><div>DATE: November 2018</div></div>		<div>LOCATIONS</div> <div>Services shown are those known to exist at date of design. Prior to commencement of excavation contact the relevant gas, electricity, water and telecommunications service providers, including the RMS, for most recent service locations and precautions that may be necessary</div>		<div>SERVICES</div> <div>Gas: — G — </div> <div>Electricity: — E — </div> <div>Water: — W — </div> <div>Sewer: — S — </div> <div>TelComm Local Cable: — T — </div> <div>TelComm Major or Optic Fibre: — MOF — </div>		<div><div><div><div></div><div>Shellharbour</div><div>CITY COUNCIL</div></div></div><div>ADMINISTRATION CENTRE SHELLHARBOUR CIVIC CENTRE 76 CYGNET AVENUE (Cnr Cygnet & College Avenue) POSTAL ADDRESS Locked Bag 155 SHELLHARBOUR CITY CENTRE NSW 2529 PH: (02) 4221 6111 FAX: (02) 4221 6016 DX26402 SHELLHARBOUR CITY CENTRE</div></div>		<div>PLAN DETAILS</div> <div>PROPOSED SHAREWAY</div> <div>CROOME ROAD to PRINCES HIGHWAY</div> <div>via. STATION ROAD</div> <div>ALBION PARK RAIL</div>				<div>FILE:</div> <div>W:\Design Projects\2018_2019 Design Projects\7C65 - Proposed Shareway, Croome Road to Princes Highway via Station Road, APR\7C65.dwg</div>		<div>REVISION</div> <div>O</div>	
<div>SURVEYED</div> <div>OFFICER: MS</div> <div>DATE: October 2018</div> <div>SURVEY MARKS:</div> <div>G.P.S.</div>						<div>DESIGNED: PCW</div> <div>DATE: November 2018</div> <div>DRAWN: PCW</div> <div>DATE: November 2018</div>		<div>SEDIMENT AND EROSION CONTROL</div> <div>Provide sediment and erosion control measures in accordance with the 'Erosion & Sediment Control' guide by the NSW Office of Environment & Heritage</div>						<div>PLAN No:</div> <div>7C65</div>		<div>SHEET:</div> <div>7 of 10</div>					

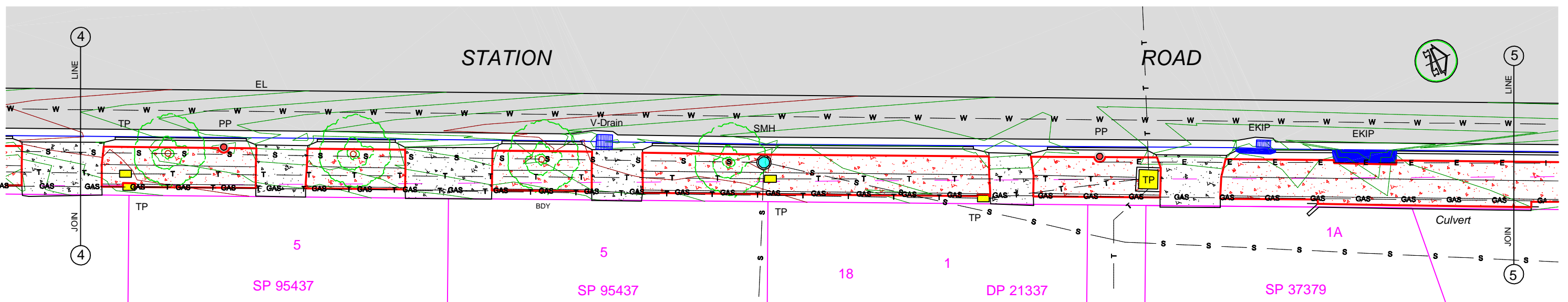
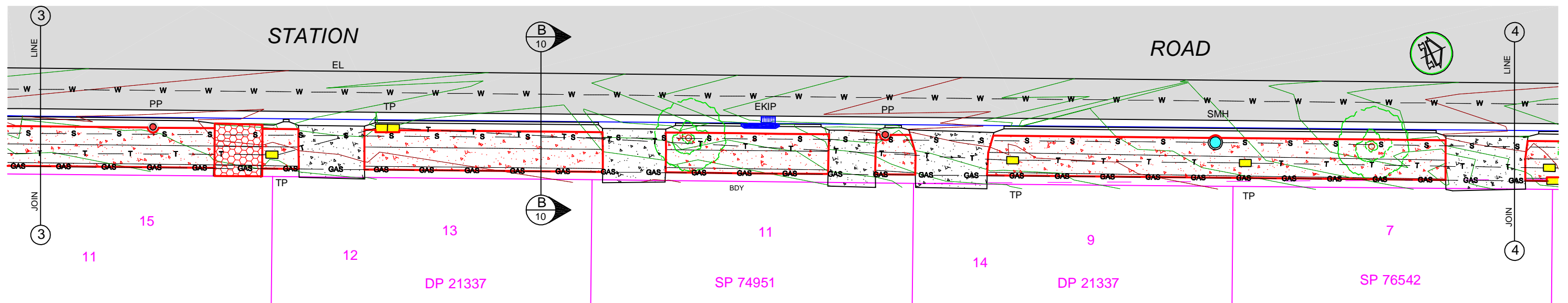
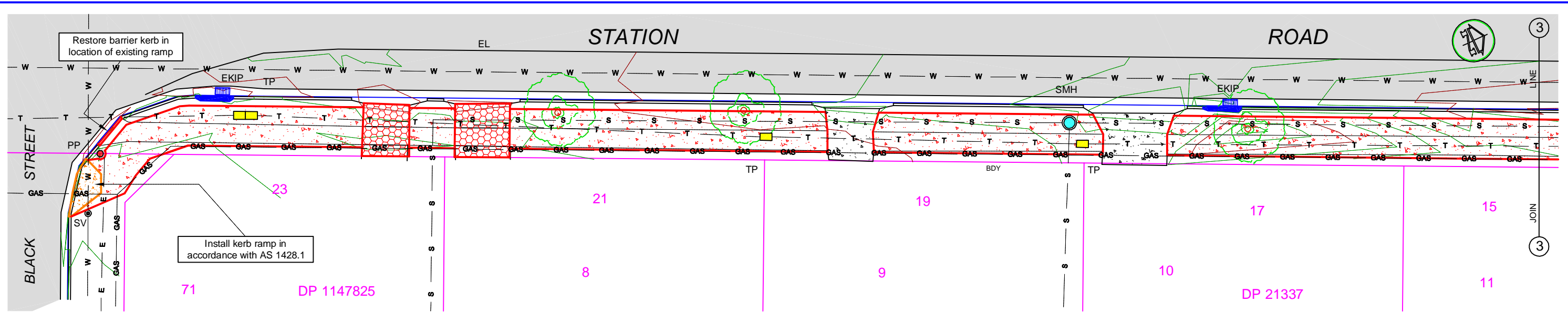

SCALES		LIST OF REVISIONS		AMENDMENT DETAILS		APPROVED - Manager Technical Services		LOCATIONS		SERVICES		LEGEND		ADMINISTRATION CENTRE		PLAN DETAILS		FILE:		REVISION	
1:125 @ A1	1:250 @ A3	REV.	DATE	OFFICER		DESIGNED:	PCW	DATE:	November 2018	DATE:	November 2018	DATE:	November 2018	DATE:	November 2018	DATE:	November 2018	DATE:	November 2018	DATE:	November 2018
SURVEYED		OFFICER: MS		DATE: October 2018		DRAWN: PCW		DATE: November 2018		SEDIMENT AND EROSION CONTROL		Provide sediment and erosion control measures in accordance with the 'Erosion & Sediment Control' guide by the NSW Office of Environment & Heritage		SHELLHARBOUR CITY COUNCIL		PROPOSED SHAREWAY		W:\Design Projects\2018_2019 Design Projects\7C65 - Proposed Shareway, Croome Road to Princes Highway via Station Road, APR\7C65.dwg		0	
G.P.S.																CROOME ROAD to PRINCES HIGHWAY via. STATION ROAD ALBION PARK RAIL		PLAN No:		SHEET:	
																		7C65		8 of 10	



ILLAWARRA

REGIONAL

AIRPORT

ROAD

STATION

U-Turn

Existing

Vehicular

Bay

JAMES

PARK

BUS SHELTER

PRINCES HWY.

Horsley Creek

SP 68912

2B

<div>SCALES</div> <div>1:125 @ A1</div> <div>1:250 @ A3</div>		<div>LIST OF REVISIONS</div> <div>REV. DATE OFFICER</div> <div>.....</div> <div>.....</div> <div>.....</div> <div>.....</div> <div>.....</div> <div>.....</div> <div>.....</div> <div>.....</div> <div>.....</div> <div>.....</div> <div>.....</div> <div>.....</div> <div>.....</div> <div>.....</div> <div>.....</div> <div>.....</div> <div>.....</div> <div>.....</div> <div>.....</div> <div>.....</div> <div>.....</div> <div>.....</div> <div>.....</div> <div>.....</div> <div>.....</div> <div>.....</div> <div>.....</div> <div>.....</div> <div>.....</div> <div>.....</div> <div>.....</div> <div>.....</div> <div>.....</div> <div>.....</div> <div>.....</div> <div>.....</div> <div>.....</div> <div>.....</div> <div>.....</div> <div>.....</div> <div>.....</div> <div>.....</div> <div>.....</div> <div>.....</div> <div>.....</div> <div>.....</div> <div>.....</div> <div>.....</div> <div>.....</div> <div>.....</div> <div>.....</div> <div>.....</div> <div>.....</div> <div>.....</div> <div>.....</div> <div>.....</div> <div>.....</div> <div>.....</div> <div>.....</div> <div>.....</div> <div>.....</div> <div>.....</div> <div>.....</div> <div>.....</div> <div>.....</div> <div>.....</div> <div>.....</div> <div>.....</div> <div>.....</div> <div>.....</div> <div>.....</div> <div>.....</div> <div>.....</div> <div>.....</div> <div>.....</div> <div>.....</div> <div>.....</div> <div>.....</div> <div>.....</div> <div>.....</div> <div>.....</div> <div>.....</div> <div>.....</div> <div>.....</div> <div>.....</div> <div>.....</div> <div>.....</div> <div>.....</div> <div>.....</div> <div>.....</div> <div>.....</div> <div>.....</div> <div>.....</div> <div>.....</div> <div>.....</div> <div>.....</div> <div>.....</div> <div>.....</div> <div>.....</div> <div>.....</div> <div>.....</div> <div>.....</div> <div>.....</div> <div>.....</div> <div>.....</div> <div>.....</div> <div>.....</div> <div>.....</div> <div>.....</div> <div>.....</div> <div>.....</div> <div>.....</div> <div>.....</div> <div>.....</div> <div>.....</div> <div>.....</div> <div>.....</div> <div>.....</div> <div>.....</div> <div>.....</div> <div>.....</div> <div>.....</div> <div>.....</div> <div>.....</div> <div>.....</div> <div>.....</div> <div>.....</div> <div>.....</div> <div>.....</div> <div>.....</div> <div>.....</div> <div>.....</div> <div>.....</div> <div>.....</div> <div>.....</div> <div>.....</div> <div>.....</div> <div>.....</div> <div>.....</div> <div>.....</div> <div>.....</div> <div>.....</div> <div>.....</div> <div>.....</div> <div>.....</div> <div>.....</div> <div>.....</div> <div>.....</div> <div>.....</div> <div>.....</div> <div>.....</div> <div>.....</div> <div>.....</div> <div>.....</div> <div>.....</div> <div>.....</div> <div>.....</div> <div>.....</div> <div>.....</div> <div>.....</div> <div>.....</div> <div>.....</div> <div>.....</div> <div>.....</div> <div>.....</div> <div>.....</div> <div>.....</div> <div>.....</div> <div>.....</div> <div>.....</div> <div>.....</div> <div>.....</div> <div>.....</div> <div>.....</div> <div>.....</div> <div>.....</div> <div>.....</div> <div>.....</div> <div>.....</div> <div>.....</div> <div>.....</div> <div>.....</div> <div>.....</div> <div>.....</div> <div>.....</div> <div>.....</div> <div>.....</div> <div>.....</div> <div>.....</div> <div>.....</div> <div>.....</div> <div>.....</div> <div>.....</div> <div>.....</div> <div>.....</div> <div>.....</div> <div>.....</div> <div>.....</div> <div>.....</div> <div>.....</div> <div>.....</div> <div>.....</div> <div>.....</div> <div>.....</div> <div>.....</div> <div>.....</div> <div>.....</div> <div>.....</div> <div>.....</div> <div>.....</div> <div>.....</div> <div>.....</div> <div>.....</div> <div>.....</div> <div>.....</div> <div>.....</div> <div>.....</div> <div>.....</div> <div>.....</div> <div>.....</div> <div>.....</div> <div>.....</div> <div>.....</div> <div>.....</div> <div>.....</div> <div>.....</div> <div>.....</div> <div>.....</div> <div>.....</div> <div>.....</div> <div>.....</div> <div>.....</div> <div>.....</div> <div>.....</div> <div>.....</div> <div>.....</div> <div>.....</div> <div>.....</div> <div>.....</div> <div>.....</div> <div>.....</div> <div>.....</div> <div>.....</div> <div>.....</div> <div>.....</div> <div>.....</div> <div>.....</div> <div>.....</div> <div>.....</div> <div>.....</div> <div>.....</div> <div>.....</div> <div>.....</div> <div>.....</div> <div>.....</div> <div>.....</div> <div>.....</div> <div>.....</div> <div>.....</div> <div>.....</div> <div>.....</div> <div>.....</div> <div>.....</div> <div>.....</div> <div>.....</div> <div>.....</div> <div>.....</div> <div>.....</div> <div>.....</div> <div>.....</div> <div>.....</div> <div>.....</div> <div>.....</div> <div>.....</div> <div>.....</div> <div>.....</div> <div>.....</div> <div>.....</div> <div>.....</div> <div>.....</div> <div>.....</div> <div>.....</div> <div>.....</div> <div>.....</div> <div>.....</div> <div>.....</div> <div>.....</div> <div>.....</div> <div>.....</div> <div>.....</div> <div>.....</div> <div>.....</div> <div>.....</div> <div>.....</div> <div>.....</div> <div>.....</div> <div>.....</div> <div>.....</div> <div>.....</div> <div>.....</div> <div>.....</div> <div>.....</div> <div>.....</div> <div>.....</div> <div>.....</div> <div>.....</div> <div>.....</div> <div>.....</div> <div>.....</div> <div>.....</div> <div>.....</div> <div>.....</div> <div>.....</div> <div>.....</div> <div>.....</div> <div>.....</div> <div>.....</div> <div>.....</div> <div>.....</div> <div>.....</div> <div>.....</div> <div>.....</div> <div>.....</div> <div>.....</div> <div>.....</div> <div>.....</div> <div>.....</div> <div>.....</div> <div>.....</div> <div>.....</div> <div>.....</div> <div>.....</div> <div>.....</div> <div>.....</div> <div>.....</div> <div>.....</div> <div>.....</div> <div>.....</div> <div>.....</div> <div>.....</div> <div>.....</div> <div>.....</div> <div>.....</div> <div>.....</div> <div>.....</div> <div>.....</div> <div>.....</div> <div>.....</div> <div>.....</div> <div>.....</div> <div>.....</div> <div>.....</div> <div>.....</div> <div>.....</div> <div>.....</div> <div>.....</div> <div>.....</div> <div>.....</div> <div>.....</div> <div>.....</div> <div>.....</div> <div>.....</div> <div>.....</div> <div>.....</div> <div>.....</div> <div>.....</div> <div>.....</div> <div>.....</div> <div>.....</div> <div>.....</div> <div>.....</div> <div>.....</div> <div>.....</div> <div>.....</div> <div>.....</div> <div>.....</div> <div>.....</div> <div>.....</div> <div>.....</div> <div>.....</div> <div>.....</div> <div>.....</div> <div>.....</div> <div>.....</div> <div>.....</div> <div>.....</div> <div>.....</div> <div>.....</div> <div>.....</div> <div>.....</div> <div>.....</div> <div>.....</div> <div>.....</div> <div>.....</div> <div>.....</div> <div>.....</div> <div>.....</div> <div>.....</div> <div>.....</div> <div>.....</div> <div>.....</div> <div>.....</div> <div>.....</div> <div>.....</div> <div>.....</div> <div>.....</div> <div>.....</div> <div>.....</div> <div>.....</div> <div>.....</div> <div>.....</div> <div>.....</div> <div>.....</div> <div>.....</div> <div>.....</div> <div>.....</div> <div>.....</div> <div>.....</div> <div>.....</div> <div>.....</div> <div>.....</div> <div>.....</div> <div>.....</div> <div>.....</div> <div>.....</div> <div>.....</div> <div>.....</div> <div>.....</div> <div>.....</div> <div>.....</div> <div>.....</div> <div>.....</div> <div>.....</div> <div>.....</div> <div>.....</div> <div>.....</div> <div>.....</div> <div>.....</div> <div>.....</div> <div>.....</div> <div>.....</div> <div>.....</div> <div>.....</div> <div>.....</div> <div>.....</div> <div>.....</div> <div>.....</div> <div>.....</div> <div>.....</div> <div>.....</div> <div>.....</div> <div>.....</div> <div>.....</div> <div>.....</div> <div>.....</div> <div>.....</div> <div>.....</div> <div>.....</div> <div>.....</div> <div>.....</div> <div>.....</div> <div>.....</div> <div>.....</div> <div>.....</div> <div>.....</div> <div>.....</div> <div>.....</div> <div>.....</div> <div>.....</div> <div>.....</div> <div>.....</div> <div>.....</div> <div>.....</div> <div>.....</div> <div>.....</div> <div>.....</div> <div>.....</div> <div>.....</div> <div>.....</div> <div>.....</div> <div>.....</div> <div>.....</div> <div>.....</div> <div>.....</div> <div>.....</div> <div>.....</div> <div>.....</div> <div>.....</div> <div>.....</div> <div>.....</div> <div>.....</div> <div>.....</div> <div>.....</div> <div>.....</div> <div>.....</div> <div>.....</div> <div>.....</div> <div>.....</div> <div>.....</div> <div>.....</div> <div>.....</div> <div>.....</div> <div>.....</div> <div>.....</div> <div>.....</div> <div>.....</div> <div>.....</div> <div>.....</div> <div>.....</div> <div>.....</div> <div>.....</div> <div>.....</div> <div>.....</div> <div>.....</div> <div>.....</div> <div>.....</div> <div>.....</div> <div>.....</div> <div>.....</div> <div>.....</div> <div>.....</div> <div>.....</div> <div>.....</div> <div>.....</div> <div>.....</div> <div>.....</div> <div>.....</div> <div>.....</div> <div>.....</div> <div>.....</div> <div>.....</div> <div>.....</div> <div>.....</div> <div>.....</div> <div>.....</div> <div>.....</div> <div>.....</div> <div>.....</div> <div>.....</div> <div>.....</div> <div>.....</div> <div>.....</div> <div>.....</div> <div>.....</div> <div>.....</div> <div>.....</div> <div>.....</div> <div>.....</div> <div>.....</div> <div>.....</div> <div>.....</div> <div>.....</div> <div>.....</div> <div>.....</div> <div>.....</div> <div>.....</div> <div>.....</div> <div>.....</div> <div>.....</div> <div>.....</div> <div>.....</div> <div>.....</div> <div>.....</div> <div>.....</div> <div>.....</div> <div>.....</div> <div>.....</div> <div>.....</div> <div>.....</div> <div>.....</div> <div>.....</div> <div>.....</div> <div>.....</div> <div>.....</div> <div>.....</div> <div>.....</div> <div>.....</div> <div>.....</div> <div>.....</div> <div>.....</div> <div>.....</div> <div>.....</div> <div>.....</div> <div>.....</div> <div>.....</div> <div>.....</div> <div>.....</div> <div>.....</div> <div>.....</div> <div>.....</div> <div>.....</div> <div>.....</div> <div>.....</div> <div>.....</div> <div>.....</div> <div>.....</div> <div>.....</div> <div>.....</div> <div>.....</div> <div>.....</div> <div>.....</div> <div>.....</div> <div>.....</div> <div>.....</div> <div>.....</div> <div>.....</div> <div>.....</div> <div>.....</div> <div>.....</div> <div>.....</div> <div>.....</div> <div>.....</div> <div>.....</div> <div>.....</div> <div>.....</div> <div>.....</div> <div>.....</div> <div>.....</div> <div>.....</div> <div>.....</div> <div>.....</div> <div>.....</div> <div>.....</div> <div>.....</div> <div>.....</div> <div>.....</div> <div>.....</div> <div>.....</div> <div>.....</div> <div>.....</div> <div>.....</div> <div>.....</div> <div>.....</div> <div>.....</div> <div>.....</div> <div>.....</div> <div>.....</div> <div>.....</div> <div>.....</div> <div>.....</div> <div>.....</div> <div>.....</div> <div>.....</div> <div>.....</div> <div>.....</div> <div>.....</div> <div>.....</div> <div>.....</div> <div>.....</div> <div>.....</div> <div>.....</div> <div>.....</div> <div>.....</div> <div>.....</div> <div>.....</div> <div>.....</div> <div>.....</div> <div>.....</div> <div>.....</div> <div>.....</div> <div>.....</div> <div>.....</div> <div>.....</div> <div>.....</div> <div>.....</div> <div>.....</div> <div>.....</div> <div>.....</div> <div>.....</div> <div>.....</div> <div>.....</div> <div>.....</div> <div>.....</div> <div>.....</div> <div>.....</div> <div>.....</div> <div>.....</div> <div>.....</div> <div>.....</div> <div>.....</div> <div>.....</div> <div>.....</div> <div>.....</div> <div>.....</div> <div>.....</div> <div>.....</div> <div>.....</div> <div>.....</div> <div>.....</div> <div>.....</div> <div>.....</div> <div>.....</div> <div>.....</div> <div>.....</div> <div>.....</div> <div>.....</div> <div>.....</div> <div>.....</div> <div>.....</div> <div>.....</div> <div>.....</div> <div>.....</div> <div>.....</div> <div>.....</div> <div>.....</div> <div>.....</div> <div>.....</div> <div>.....</div> <div>.....</div> <div>.....</div> <div>.....</div> <div>.....</div> <div>.....</div> <div>.....</div> <div>.....</div> <div>.....</div> <div>.....</div> <div>.....</div> <div>.....</div> <div>.....</div> <div>.....</div> <div>.....</div> <div>.....</div> <div>.....</div> <div>.....</div> <div>.....</div> <div>.....</div> <div>.....</div> <div>.....</div> <div>.....</div> <div>.....</div> <div>.....</div> <div>.....</div> <div>.....</div> <div>.....</div> <div>.....</div> <div>.....</div> <div>.....</div> <div>.....</div> <div>.....</div> <div>.....</div> <div>.....</div> <div>.....</div> <div>.....</div> <div>.....</div> <div>.....</div> <div>.....</div> <div>.....</div> <div>.....</div> <div>.....</div> <div>.....</div> <div>.....</div> <div>.....</div> <div>.....</div> <div>.....</div> <div>.....</div> <div>.....</div> <div>.....</div> <div>.....</div> <div>.....</div> <div>.....</div>	
---	--	--	--

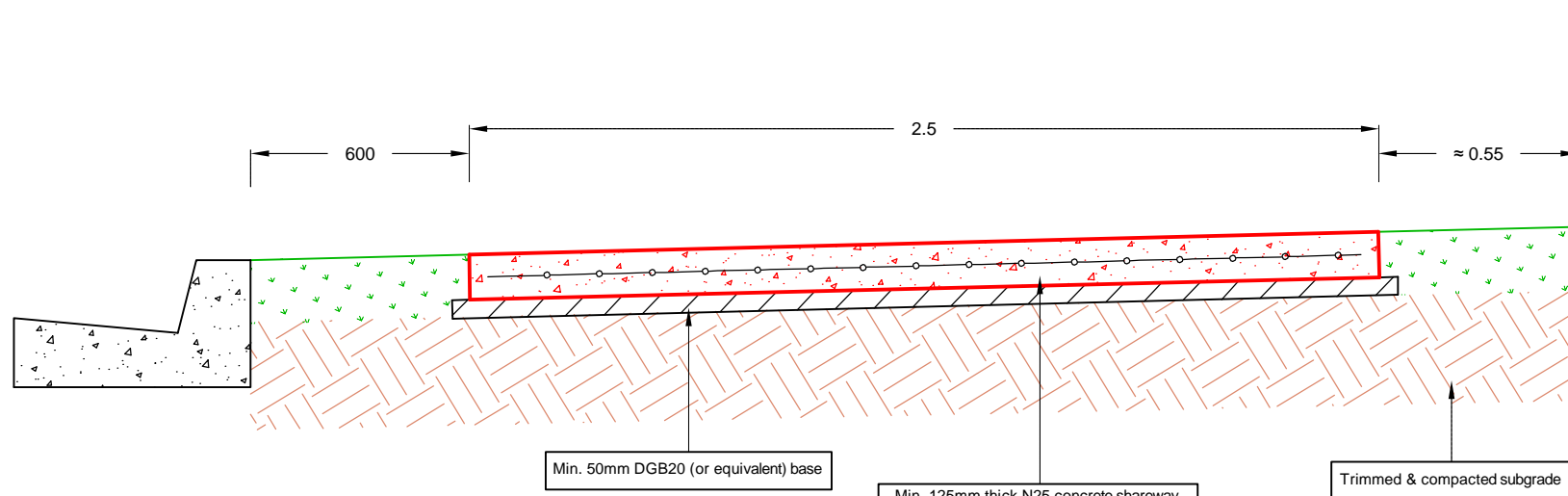

TYPICAL PATH X - SECTION A - A (along Tongarra Road)

1:10 @ A1
1:20 @ A3

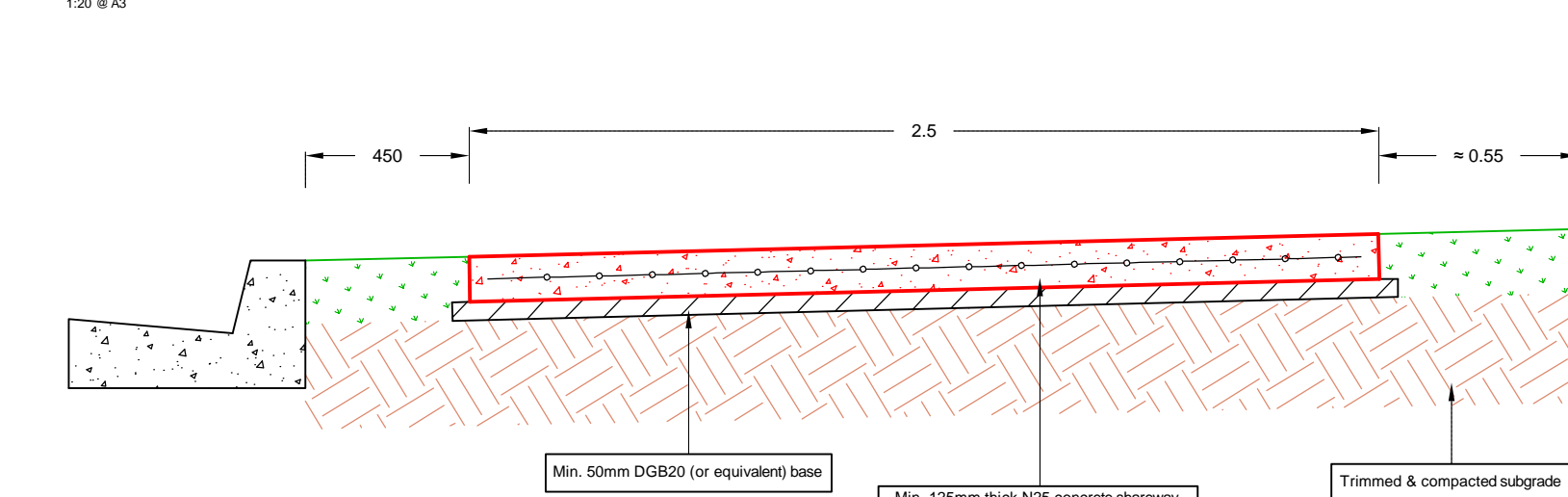

TYPICAL PATH X - SECTION B - B (along Station Road)

1:10 @ A1
1:20 @ A3

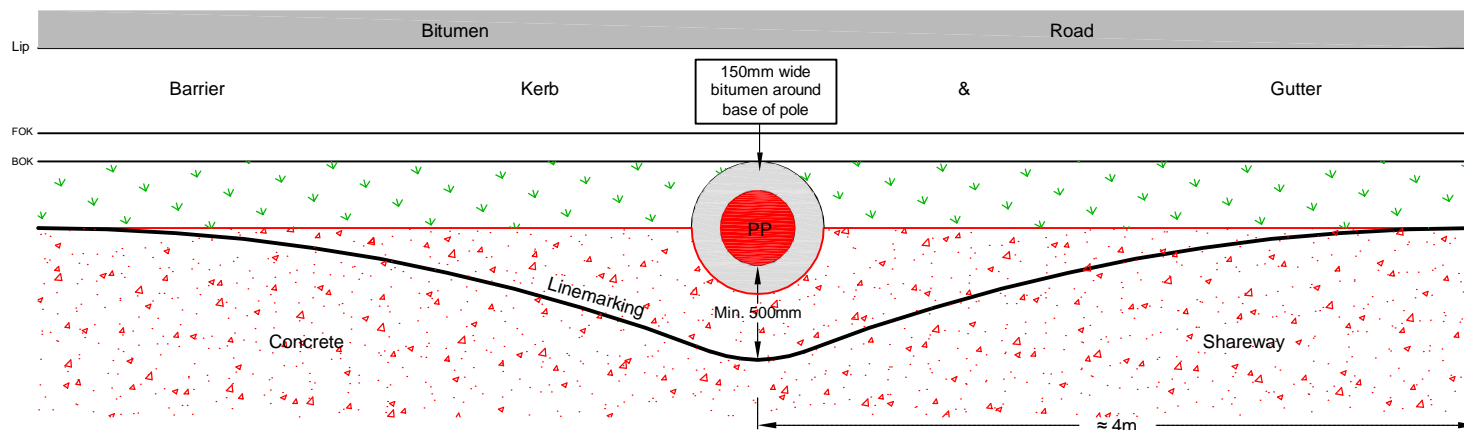

**TYPICAL SHAREWAY
ARRANGEMENT @ POWER POLES**

1:20 @ A1
1:40 @ A3

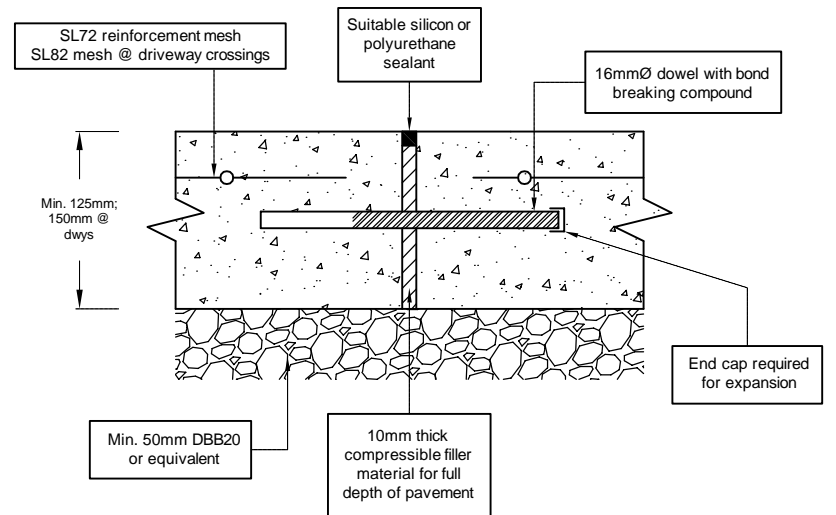

TYPICAL DOWELLED EXPANSION JOINT @ 12m

N.T.S.

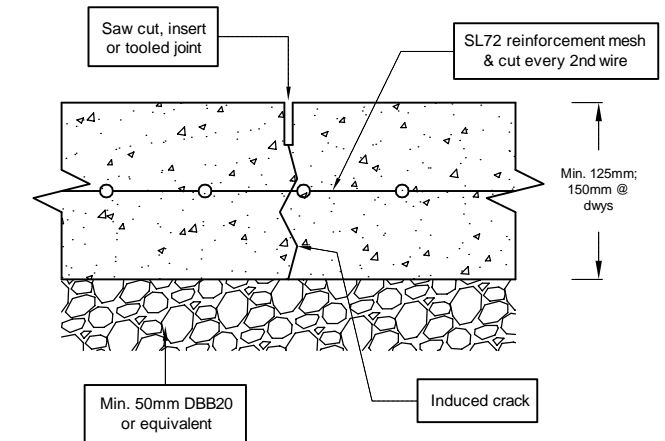

TYPICAL CONTROL JOINT @ 3m

(or Key Joint where a Connolly Key Joint or similar is used)
N.T.S.

NOTES

Where new shareway meets existing concrete works, a dowelled expansion joint is to be constructed using a suitable compressible filler material with min. 300mm x 16mmØ dowels @ 400mm ctrs.

Apply non-slip broom finish to concrete surface, perpendicular to line of travel.

Pathway crossfall - 2.5% to 5%

SCALES	LIST OF REVISIONS	AMENDMENT DETAILS	APPROVED - Manager Technical Services	LOCATIONS	SERVICES	LEGEND	ADMINISTRATION CENTRE	PLAN DETAILS	FILE:	REVISION
1:125 @ A1 1:250 @ A3	REV. DATE OFFICER		DATE: November 2018	Services shown are those known to exist at date of design. Prior to commencement of excavation contact the relevant gas, electricity, water and telecommunications service providers, including the RMS, for most recent service locations and precautions that may be necessary	Gas: — G — Electricity: — E — Water: — W — Sewer: — S — TelComm Local Cable: — T — TelComm Major or Optic Fibre: — MOF —		SHELLHARBOUR CIVIC CENTRE 76 CYGNET AVENUE (Cnr Cygnet & College Avenue) POSTAL ADDRESS Locked Bag 155 SHELLHARBOUR CITY CENTRE NSW 2529 PH: (02) 4221 6111 FAX: (02) 4221 6016 DX26402 SHELLHARBOUR CITY CENTRE	PROPOSED SHAREWAY CROOME ROAD to PRINCES HIGHWAY via. STATION ROAD ALBION PARK RAIL	W:\Design Projects\2018_2019 Design Projects\7C65 - Proposed Shareway, Croome Road to Princes Highway via Station Road, APR\7C65.dwg	O
SURVEYED OFFICER: MS DATE: October 2018 SURVEY MARKS: G.P.S.			DESIGNED: PCW DATE: November 2018 DRAWN: PCW DATE: November 2018						PLAN No: 7C65	SHEET: 10 of 10